

Nova 1 Door MDF Workstation/Cupboard 400mm Wide (Nova-AGS4)

Before you commence the assembly process, we recommend that you read these instructions thoroughly beforehand to familiarise yourself with the assembly process and to also check that you have the correct components. If for any reason you need assistance, you can find our contact details on the top of page of these instructions.

We highly recommend that any assembly is carried out on a flat, level surface if possible and that you use another person to assist you if necessary. **Also, all parts have stickers with part numbers attached and for your convenience all guide holes are pre-drilled.**

Package contents

2x Side panels (Part nr: AGS4_1)
2x Partitions (Part nr: AGS4_2)
1x Base (Part nr: AGS4_3)
1x Back panel (Part nr: AGS4_4)
1x Doors (Part nr: AGS4_5)
1x Shelves (Part nr: AGS4_6)
1x Tabletop (Part nr: AGS4_7)
3x Leg panel (Part nr: AGS_2)
Bundle with fixings

Tools required

Electric screwdriver
No.2 and No.3 Pozi bits
Phillips Screwdriver
Hammer



Step 1

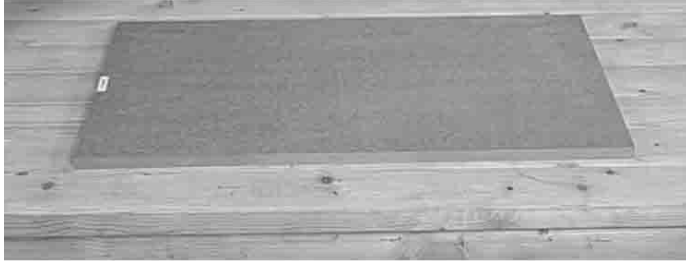

Lay the side panel (**Part nr: AGS4_1**) on a flat even surface.

Step 2

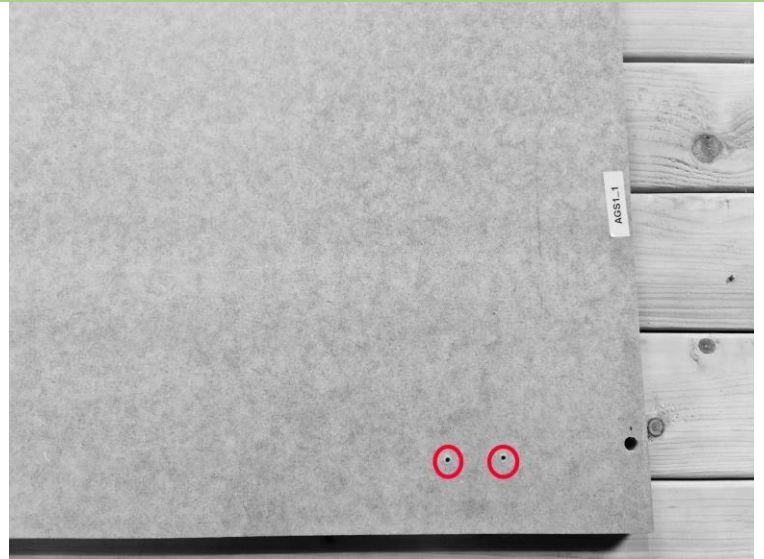

Take 4 hinge plates and prepare 4x16mm wood screws. Make sure you are using pre-drilled guide holes.

Step 2.1

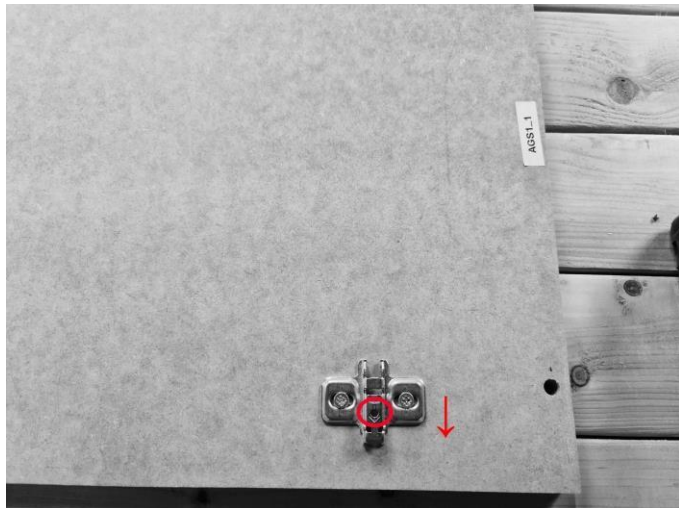

Make sure that a small arrow on hinge plate facing outwards.

Step 3



Secure two hinge plates on side panel. Repeat steps 2 to 2.1 for the second side panel (AGS4_1).

Step 4



Take base panel (AGS4_3) and align with side panel (AGS4_1) pre-drilled guide holes as shown in step 5.

Step 5

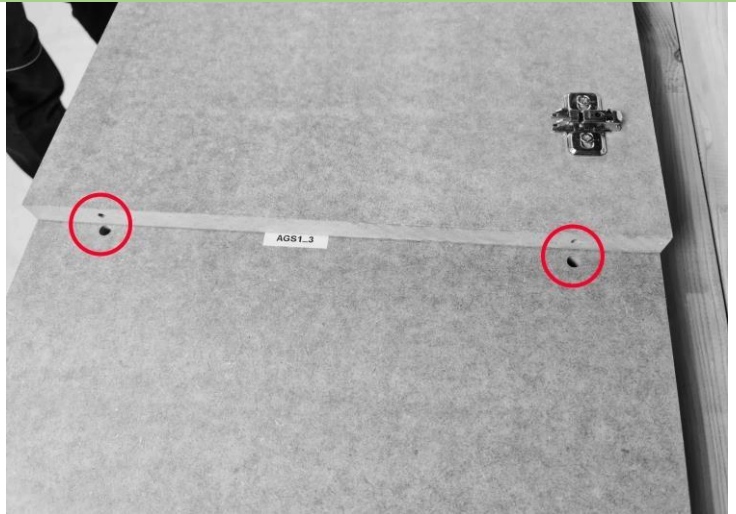

Flip your side panel of the side together with your base panel and secure with confirmat screws as shown in step 5.1

Step 5.1

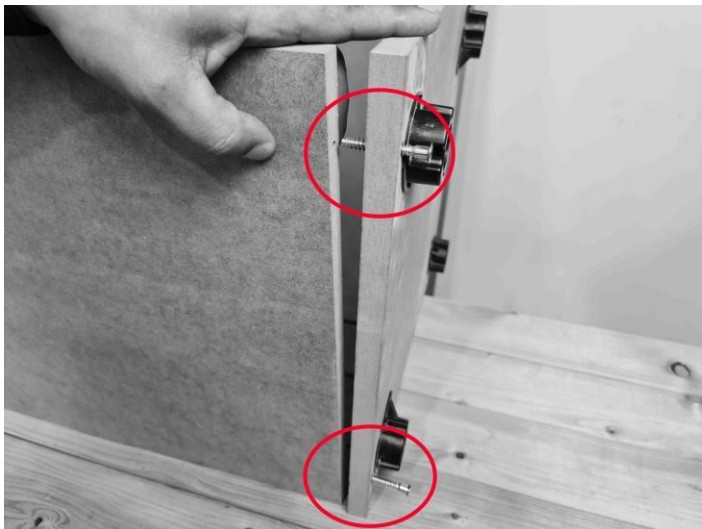

In this step you might require an assistant, to hold you a side panel. Repeat steps 5 to 5.1 to secure your second side panel to the base.

Step 6

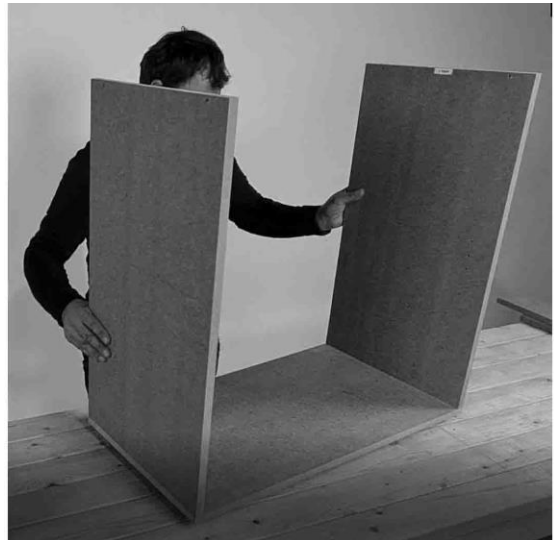

Flip your finished construction to a upward position as shown in the picture.

Step 7

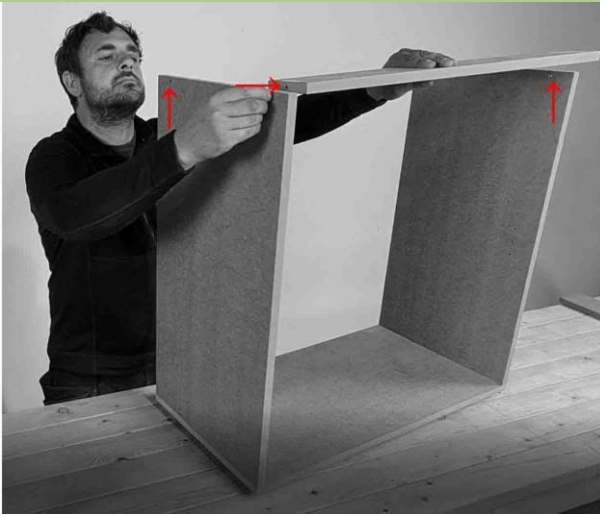

Take both partitions (AGS4_2) align with pre-drilled guide holes and secure with provided confirmat screws.

Step 8

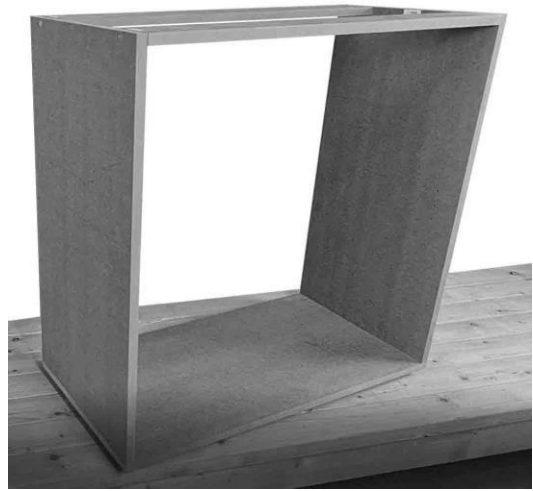

At this stage your item should look like this.

Step 9

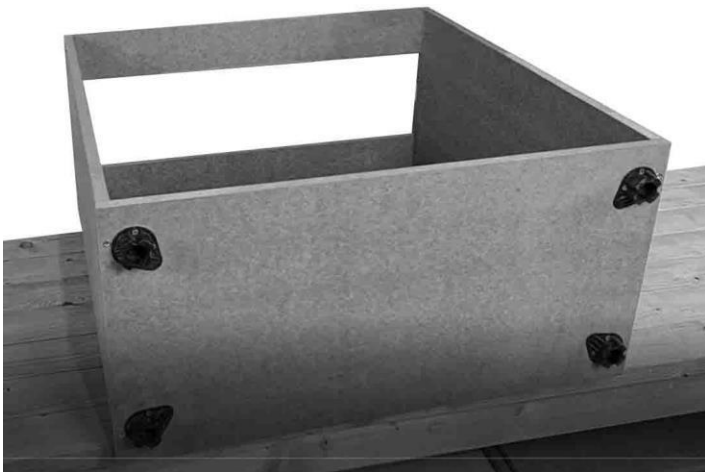

****IMPORTANT****

Now, flip your cabinet as shown in the picture. Make sure that hinge plates are facing down.

****IMPORTANT****

Step 10



Now take your back panel (AGS4_4) and place on top of your cabinet back.

Step 11



Secure back panel with provided nails using hammer. Make sure that nails are spaced out approximately 30mm from each corner.

Step 12

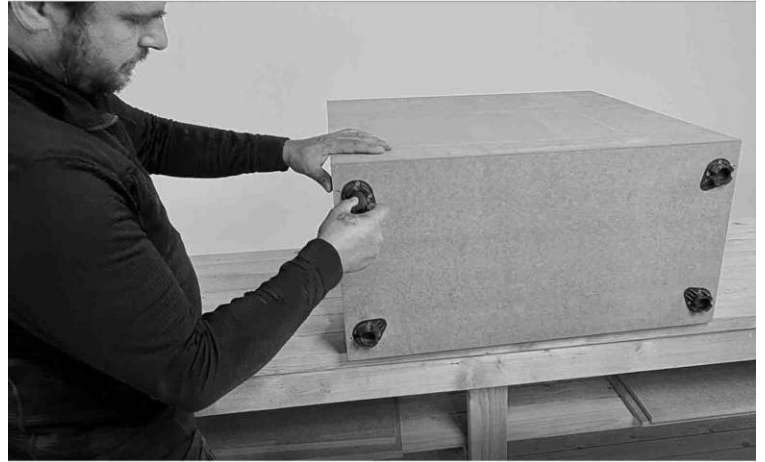

At this stage, take 4 cabinet legs and secure them into place as shown in the picture. These legs are adjustable height 100mm to 130mm. You can adjust them at this stage or later when you will position your cabinet into upright position.

Step 13



Flip your finished construction to upright position. Take your tabletop (AGS4_7) and secure via pre-drilled guide holes as shown in the picture.

****IMPORTANT****

**Make sure that your tabletop is flush with back panel.
Also, rounded tabletop edge should be on top.**

****IMPORANT****

Step 14

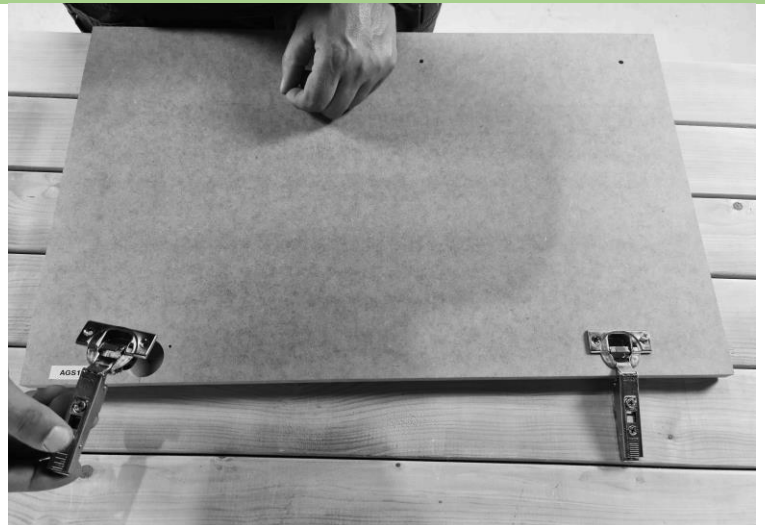

Now take your door (1x AGS4_5). Place hinges into pre-drilled holes and secure with wood screws 4x16mm. Repeat this step for all three doors.

Step 15



At this stage, take door (AGS4_5) and secure it into position as shown in the picture.

****IMPORTANT****

insert the front of the plate in to front arm of the hinge.
Now press back arm of the hinge until you hear the click.

****IMPORTANT****

Step 16



Now, using pre-drilled guide holes secure cabinet handles.

Step 17



At this stage your cabinet should look like this. However, when you install the doors, they may be out of alignment.

Step 18

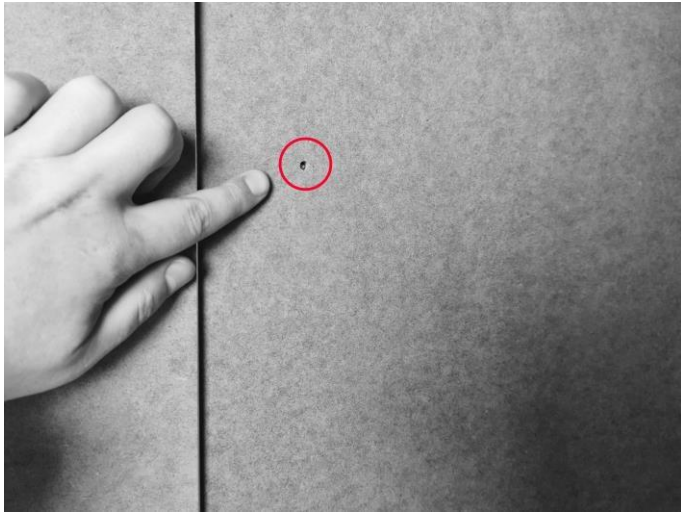

Start first by adjusting machine screw marked as number one on the arm of the hinge, this will adjust your door left-to-right or horizontal position. If you need to adjust in and out position simple adjust cam-screw marked as number two. To adjust up and down or vertical position, simple release hinge plate.

Step 19

This cupboard has adjustable height shelves.

Step 20

Please use provided pegs to setup your shelf at your required height, and fit shelf.

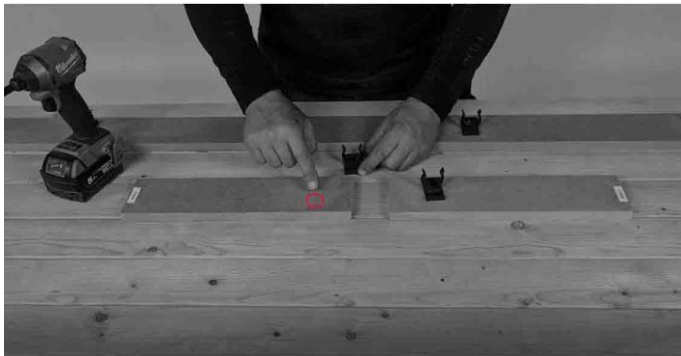
Step 21

Last step is to cover legs with a panel. Take leg panels (AGS_2) and secure leg supports using pre-drilled guides and wood screws.

Step 22

Take shorter and longer braces and align predrilled guide holes.

Step 23

Secure both panels using confirmat screws. Repeat steps for the other side.

Step 24

Take your finished leg panel and clip it to the legs.

****IMPORTANT****

If you have more than one Nova product, we strongly advise to connect them together via guide holes, which you can find in each side panel corner. Also, please note that cabinets and wall cupboards need fixing to walls conventionally using wall plugs and screws suitable for your wall material. Please employ a tradesman if in doubt.

Step 1



To connect cabinet to other cabinet, use pre-drilled guide holes as shown in the picture. This should be your last step, when you decided about the layout of your Nova Garage Cabinet Systems.

Step 1.1



Your 2-door cabinet is now completed!

We hope that you found your product quick and easy to assemble but if you require further assistance or have any questions you can contact us via details above.